

ER70-2100-II

EFORT

ER70-2100-II,
Maxium payload 70 kg with maxium reach 2100 mm.

Highlights

Based on platform-based product design, we optimize the structural design of the industrial robot body and integrate the latest control systems and algorithms, achieving top-tier precision; Multiple specific application software could be integrated, with soft PLC and a variety of field bus interface, which enable customers easily face various application challenges.

Applications

It can be used in handling operations, assembling, polishing, deburring, etc.

Industries

Suitable for auto parts, lithium cell, photovoltaic, food and beverage, building materials, logistics and warehousing and other industries.



EFORT Intelligent Robot Co., Ltd.

PHONE: (00 86) 400-052-8877

ADDRESS: No.96 East Wanchun Road, China(Anhui) Pilot

Free Trade Zone Wuhu Area, Wuhu, Anhui Province, China

WWW.EFORT.COM.CN

SPECIFICATIONS

Model	ER70-2100-II	
Type	Articulated	
Controlled axes	6 Axes	
Max. payload on wrist	70 kg	
Repeatability	±0.05 mm	
Robot weight	560 kg	
Reach	2100 mm	
Robot IP grade	IP54	
Cabinet IP grade	IP54	
Drive mode	AC servo drive	
Installation	Floor	
Installation enviroment	Ambient temperature	0~45 °C
	Ambient humidity	RH≤80% (No dew nor frost allowed)
	Vibration acceleration	4.9 m/s ² (<0.5 G)

Allowable load moment at wrist	J4	185 N·m
	J5	185 N·m
	J6	120 N·m
Allowable load inertia at wrist	J4	13 kg·m ²
	J5	13 kg·m ²
	J6	10 kg·m ²
Maximum speed	J1	190°/sec
	J2	160°/sec
	J3	190°/sec
	J4	300°/sec
	J5	240°/sec
	J6	400°/sec
Motion range	J1	±180°
	J2	+70°-150°
	J3	+170°-75°
	J4	±200°
	J5	±120°
	J6	±360°

OPERATING SPACE

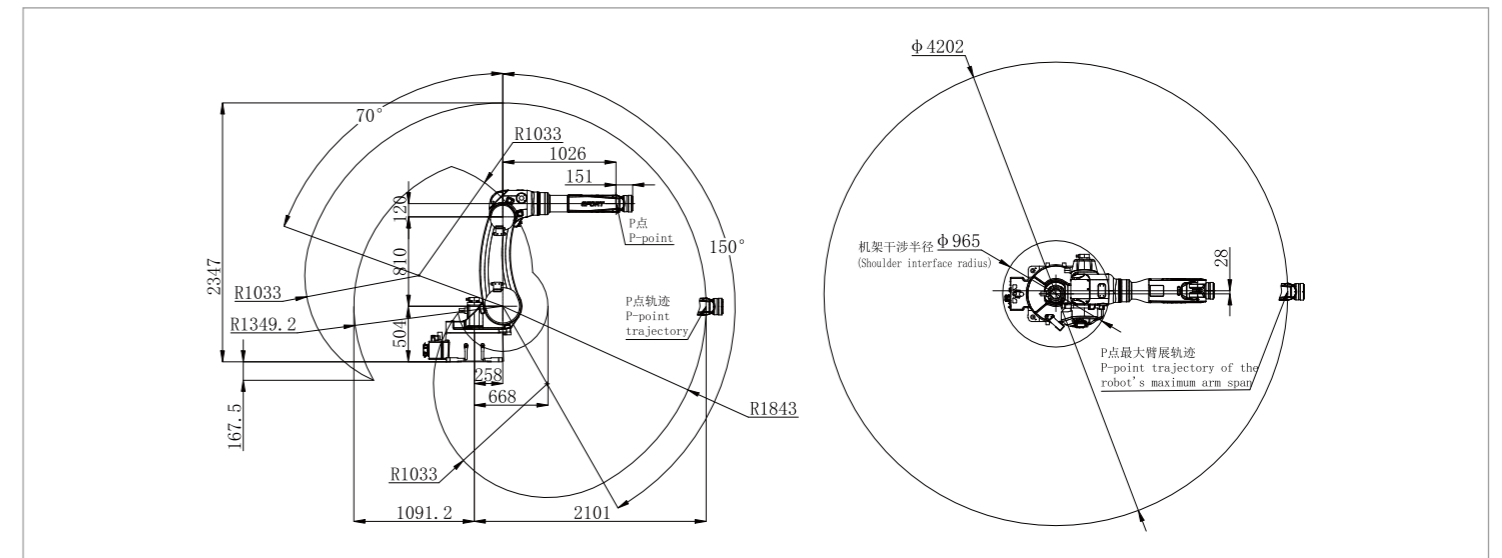

BASE MOUNTING SIZE

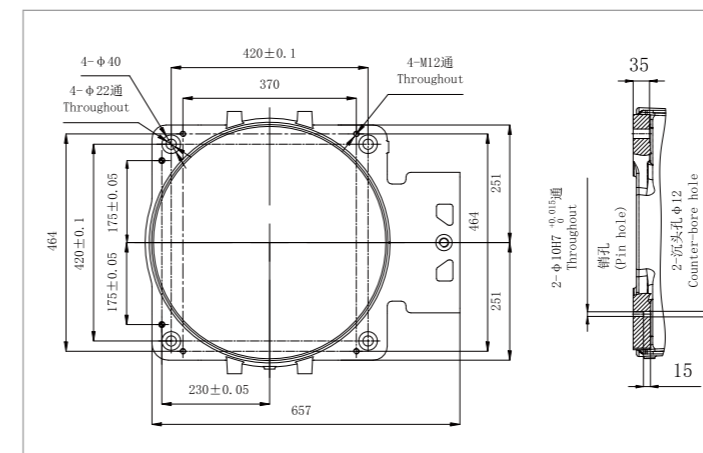

END FLANGE MOUNTING SIZE

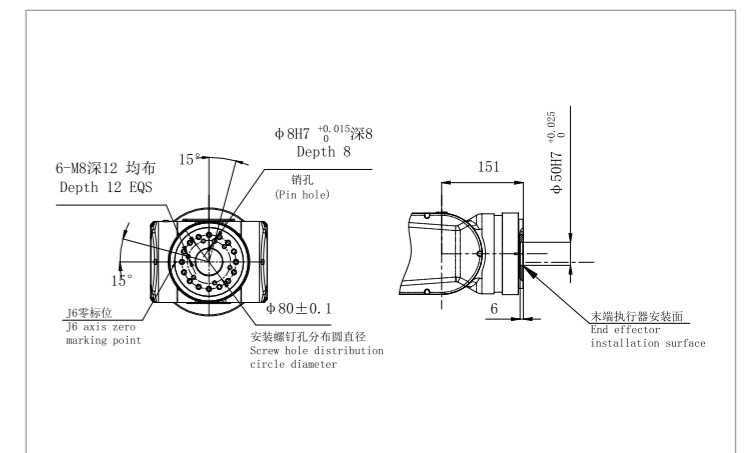

*The final interpretation right belongs to EFORT Intelligent Robot Co., Ltd. Any updates will be made without prior notice.

Information Release Time 2025/11